

Low Loss SAW Filter 67.7 MHz Filter

Bandwidth 0.14 MHz

Part Number A180-67.7M1

Complies with Directive 2002/95/EC (RoHS)

PRELIMINARY DATA

Typical performance

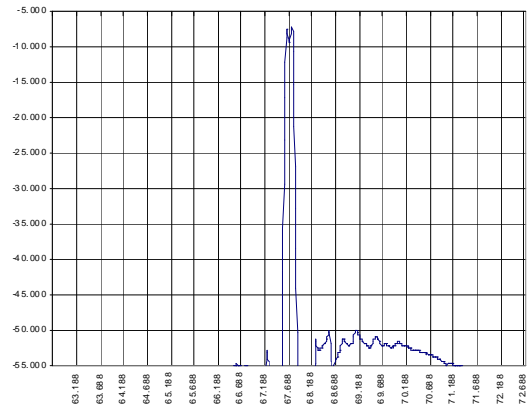
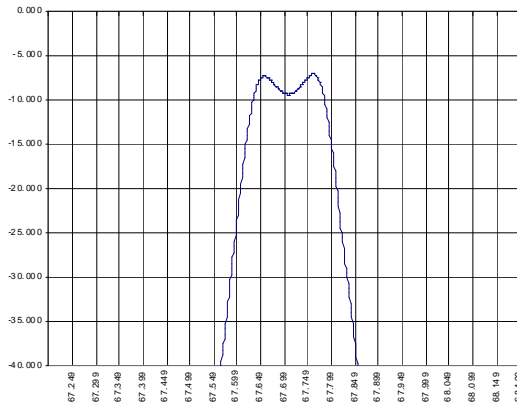

Specifications

Parameter	Unit	Min	Typ	Max
Central frequency	MHz	67.690	67.700	67.710
Inserted loss (unmatched)	dB	5	6	7
Bandwidth @-3dB	MHz	0.13	0.14	0.16
Bandwidth @-40dB	MHz	0.35	0.36	0.37
Amplitude ripple (in bandwidth 0.12 MHz)	dB	-	1	2
Ultimate rejection	dB	-	60	-
Substrate			36 YX quartz	
Temperature range	°C	-55		85

Notes:

1. The design, manufacturing process, and specifications of this filter are subject to change.
2. Specification valid for measurements in AEC test fixture

Case

DIP 18

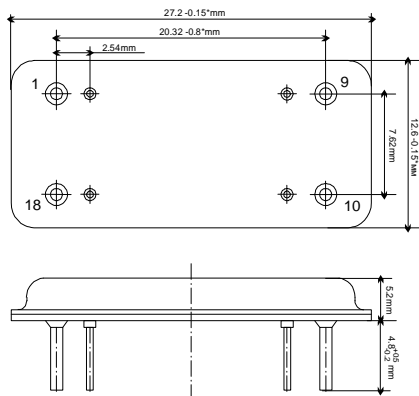

Matching

